

DEFINITE PURPOSE CONTACTORS

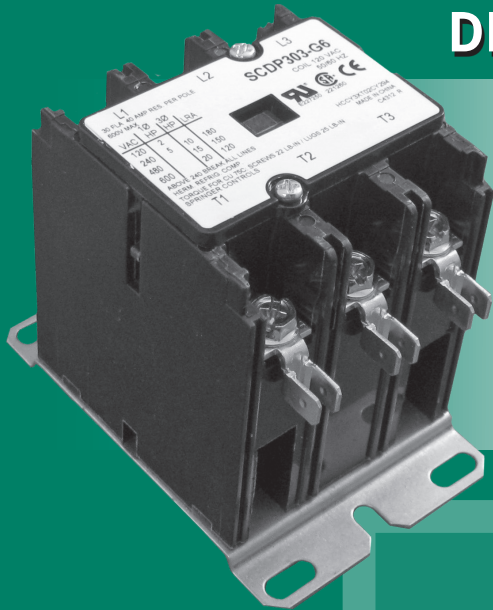

SPRINGER
controls company

Index
D

Springer Controls Definite Purpose (SCDP) Contactors are used in applications where the control requirements are well defined. This includes the controls of motors, power supplies, heating elements, lighting, HVAC fans and compressors.

Springer Controls maintains a large inventory of 25, 30 and 40 amp contactors as well as 50 amp through 90 amp. The contactors are available in 1, 2 and 3 poles along with a full range of coil voltages. All contactors are UL approved.

DEFINITE PURPOSE CONTACTORS;

Description / Nomenclature	D2
Auxiliary Switches / Terminations	D3
25 Amp through 40 Amp DP's	D4
25 - 40 Amp Electrical Ratings & Dimensions	D5
50 Amp through 90 Amps DP's	D6
50 - 90 Amp Electrical Ratings & Dimensions	D7

DESCRIPTION

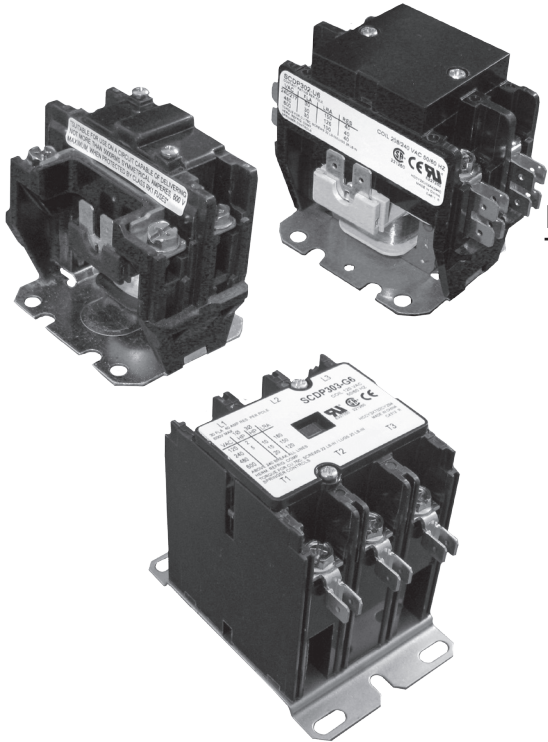

Description

- Springer Controls Definite Purpose (SCDP) Contactors are used for control of Motors, Power Supplies, Heating Elements, Lighting, HVAC Fans and Compressors.
- Available from 25 to 90 amp current rating.
- 1, 2 & 3 pole available.
- Full range of coil voltages available
- UL approved (UL508 File No. E227250)
- Silver Cadmium Oxide Contacts
- Temperature Range -40 °F to 150 °F
- Insulation System 130 °c Class B

Part Number Nomenclature

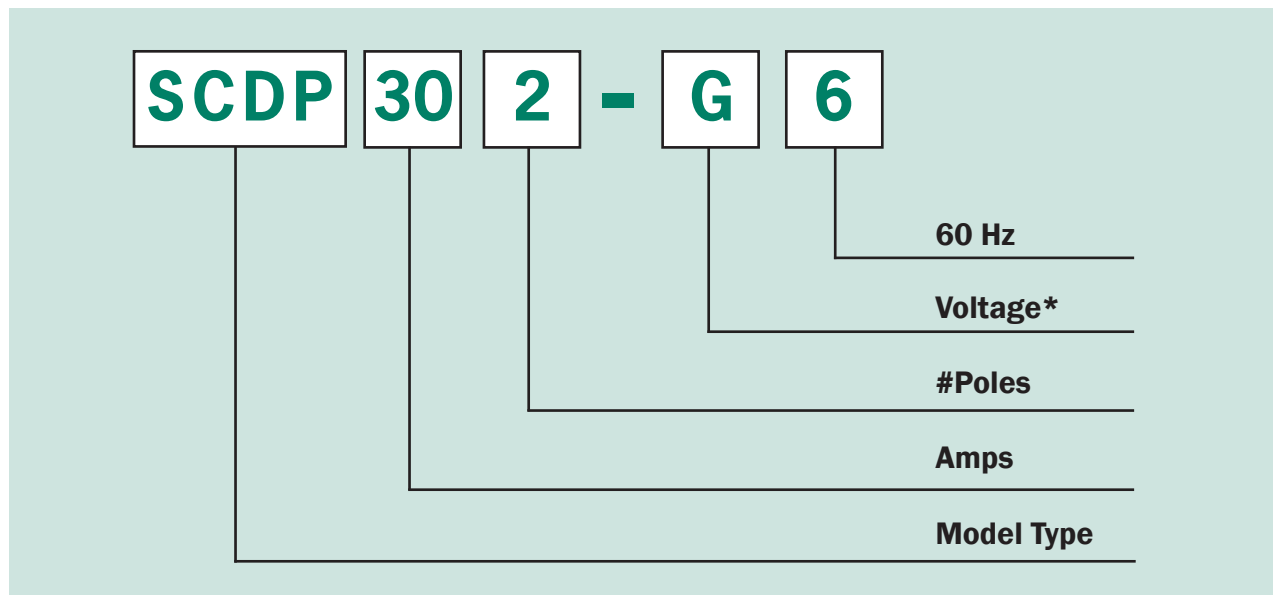

* Coil Voltage

Volts AC	24	120	208 - 240	277	480
60 Hz	B	G	U	W	T

Auxiliary Switches

3 Pole Auxiliaries for 25 - 40 FLA DP's

Configuration	Termination	Catalog No.	Price
1 NO / 1 NC	Quick Connect (.25")	SCDP-AUX25-40-11-QC	\$15.00
1 NO / 1 NC	Screw Terminal (#6-32)	SCDP-AUX25-40-11-SC	\$15.00
SPDT*	Quick Connect (.25")	SCDP-AUX25-40-SPDT	\$10.00
(2) SPDT*	Quick Connect (.25")	SCDP-AUX25-40-2SPDT	\$20.00

*10 amp, 300 VAC rated

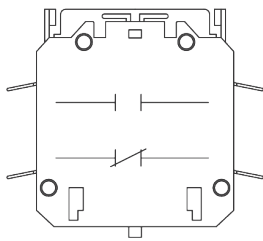

**1 NO / 1 NC
quick connects**

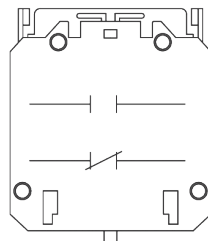

**1 NO / 1 NC
screw terminals**

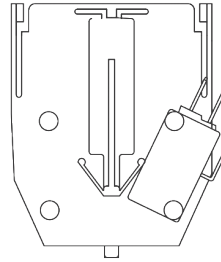

**One SPDT
switch per side**

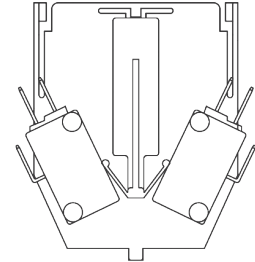

**Two SPDT
switches per side**

3 Pole Auxiliaries for 50 - 90 FLA DP's

Configuration	Termination	Catalog No.	Price
1 NO	Quick Connect (.25")	SCDP-AUX50-90-10-QC	\$15.00
1 NC	Quick Connect (.25")	SCDP-AUX50-90-01-QC	\$15.00
1 NO / 1 NC	Quick Connect (.25")	SCDP-AUX50-90-11-QC	\$23.00
2 NO	Quick Connect (.25")	SCDP-AUX50-90-20-QC	\$23.00

Terminations - DP Contactors

Standard on
20 - 30 FLA

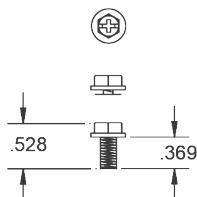

#10-32 combination
phillips, slotted

40 FLA lug

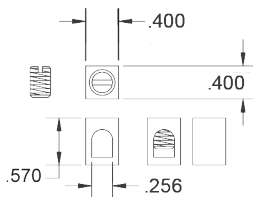

14 - 4 AWG Cu/Al

50/60 FLA lug

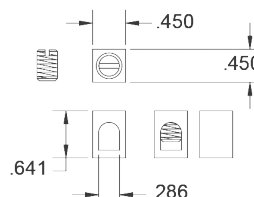

14 - 2 AWG Cu/Al

75/90 FLA lug

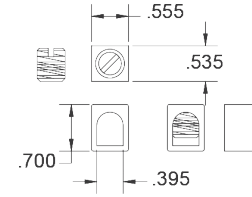

14 - 1 AWG Cu/Al

Discount Schedule SC-40

25 AMP THROUGH 40 AMP DP's

25 amp through 40 amps SCDP Contactors

D4

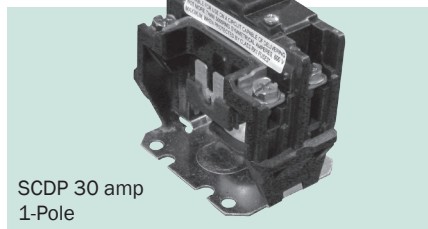

SCDP 30 amp
1-Pole

1 Pole

Full Load Amps	Resistive Amps	Catalog No.	Price
25	30	SCDP251 - * 6	\$26.00
30	40	SCDP301 - * 6	\$28.00
40 [△]	50	SCDP401 - * 6	\$31.00

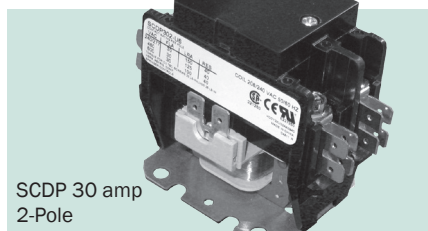

SCDP 30 amp
2-Pole

2 Pole

Full Load Amps	Resistive Amps	Catalog No.	Price
25	30	SCDP252 - * 6	\$32.00
30	40	SCDP302 - * 6	\$33.00
40 [△]	50	SCDP402 - * 6	\$38.00

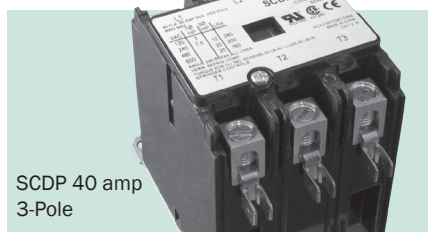

SCDP 40 amp
3-Pole

3 Pole

Full Load Amps	Resistive Amps	Catalog No.	Price
25	35	SCDP253 - * 6	\$55.00
30	40	SCDP303 - * 6	\$55.00
40 [△]	50	SCDP403 - * 6	\$60.00

[△] 40 amp DP's utilize LUG terminations (see Page D3)

* Coil Voltage

Volts AC	24	120	208 - 240	277	480
Suffix (*)	B	G	U	W	T

Coil Ratings

COIL RATINGS: 25 amp through 40 amp

	1 POLE	2 POLE	3 POLE
Nominal In-Rush VA @ 60 Hz.	28	30	60
Nominal Sealed VA @ 60 Hz.	5	6.5	6
Control Power Transformer (CPT) - VA	10	12	21

Discount Schedule SC-40

ELECTRICAL RATINGS & DIMENSIONS

D5

Electrical Ratings; 25 - 40 amp SCDP Contactors

Full Load Amps	Resistive Amps @ 600VAC	Locked Rotor Amps @ 240/277VAC	Locked Rotor Amps @ 480VAC	Maximum Horsepower		
				Voltage	Single Phase	Three Phase
1 Pole Contactors						
25	35	150	125	120	1	-
				240	2	-
30	40	150	125	120	1	-
				240	2	-
40	50	200	160	120	2	-
				240	3	-
2 Pole Contactors						
25	35	150	125	120	2	-
				240	3	-
30	40	150	125	120	2	-
				240	3	-
40	50	200	160	120	2	-
				240	3	-
3 Pole Contactors						
25	35	150	125	120	2	-
				240/277	5	10
				480	-	15
30	40	150	125	120	2	-
				240/277	5	10
				480	-	15
40	50	200	160	120	3	-
				240/277	7.5	10
				480	-	20

Dimensions: 1, 2, 3 Pole / 25 - 40 amp SCDP Contactors

1 Pole Dimensions (inches)
(weight = .5 lbs)

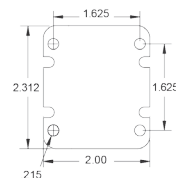
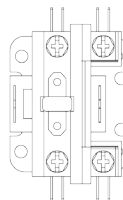
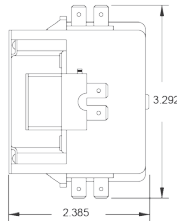

2 Pole Dimensions (inches)
(weight = .6 lbs)

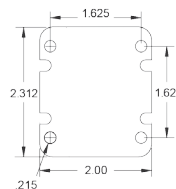
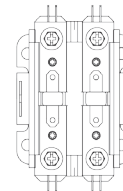
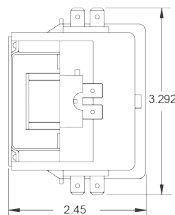

3 Pole Dimensions (inches)
(weight = 1.0 lbs)

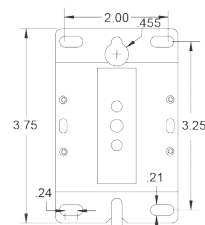
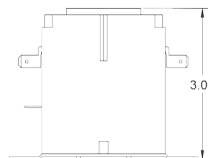
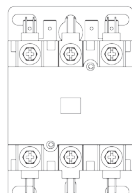

50 AMP THROUGH 90 AMP DP's

50 Amp through 90 Amp SCDP Contactors

D6

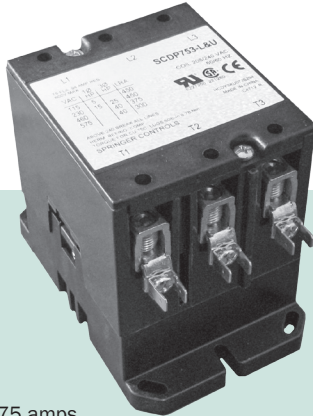

SCDP 75 amps
3-Pole

3 Pole

Full Load Amps	Resistive Amps	Catalog No.	Price
50	65	SCDP503 - * 6	\$144.00
60	75	SCDP603 - * 6	\$151.00
75	93	SCDP753 - * 6	\$370.00
90	120	SCDP903 - * 6	\$385.00

* Coil Voltage

Volts AC	24	120	208 - 240	277	480
Suffix (*)	B	G	U	W	T

Coil Ratings

COIL RATINGS: 50 amp through 90 amp - 3 POLE

	50-60 Amp	75-90 Amp
Nominal In-Rush VA @ 60 Hz.	130	240
Nominal Sealed VA @ 60 Hz.	13	27
Control Power Transformer (CPT) - VA	45	80

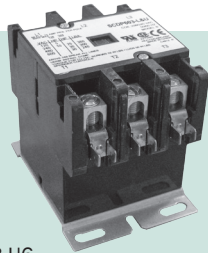

SCDP603-U6
60 amp, 3-Pole, 208-240V

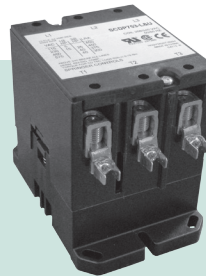

SCDP753-U6
75 amp, 3-Pole, 208-240V

Discount Schedule SC-40

ELECTRICAL RATINGS & DIMENSIONS

D7

Electrical Ratings; 50 - 90 Amp SCDP Contactors

Full Load Amps	Resistive Amps @ 600VAC	Locked Rotor Amps @ 240/277VAC	Locked Rotor Amps @ 480VAC	Maximum Horsepower		
				Voltage	Single Phase	Three Phase
3 Pole Contactors						
50	65	300	250	120	3	-
				208	7.5	15
				240	10	15
				480	-	25
				600	-	25
60	75	360	300	120	5	-
				208	7.5	25
				240	10	25
				480	-	30
				600	-	30
75	93	450	375	120	5	-
				208	10	20
				240	15	25
				480	-	40
				600	-	40
90	120	540	450	120	7.5	-
				208	15	25
				240	20	30
				480	-	50
				600	-	50

Dimensions: 3 Pole / 50 - 90 Amp SCDP Contactors

50 - 60 FLA Dimensions (inches) (weight = 2.0 lbs)

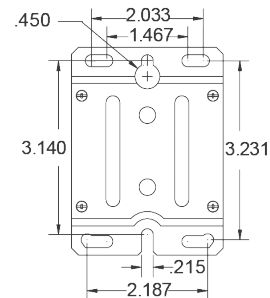
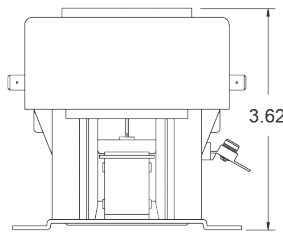
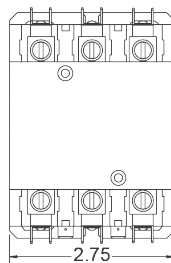

75- 90 FLA Dimensions (inches) (weight = 4.0 lbs)

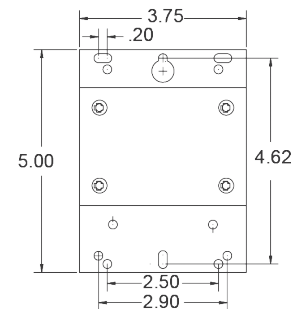
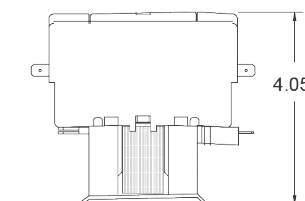
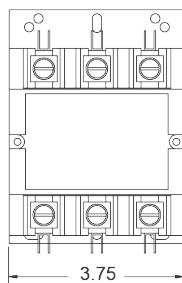



Welcome to the new edition of the Springer Controls Company, Inc. **Product Guide to Definite Purpose Contactors.** This section reflects our continuing commitment to our customers to provide complete, up-to-date product information and technical data. We appreciate your choosing Springer Controls and we will continue to update this information as well as provide new products to meet today's demands for electrical control products.

IEC Contactors

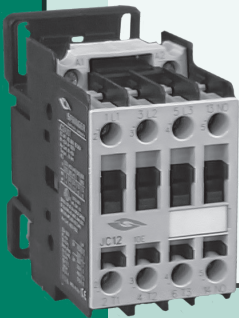

Assembled Starters



Manual Motor Starters



Solid State Contactors



www.springercontrols.com

Visit our site, it includes new product information, complete product data with downloads, installation instructions, along with other Springer Control news.



96074 Chester Road --- Yulee, Florida, 32097
Phone: (904) 225-0575 --- Fax: (904) 225-9084